

ILLUSTRATED PARTS BREAKDOWN

TK50-D/R TAPE DRIVE SUBSYSTEM

HOW TO USE THE IPB

GENERAL

This IPB is compiled following the organization and nomenclature of the engineering drawing structure.

MAJOR ASSEMBLY LOCATOR

The Major Assembly Locator (first illustration) is an index that provides a description and a figure reference for all illustrations used in this manual.

INDENTED PARTS LIST

This manual identifies each assembly being broken down (figure reference callout), and all parts of that assembly. Further breakdown of an assembly is shown by an asterisk (*) preceding the item callouts in the Description Column. The number of asterisks preceding an item is used to denote the subordination of that item with respect to the Major Assembly. A single asterisk preceding an item description indicates that the item is part of the major assembly being illustrated. Items that are subordinate to single asterisks items, are denoted by two asterisks (**) and immediately follow the related single asterisk item. Additional asterisks are used, as required, to denote further subordination. This system of part identification, provides a means for the user to identify the next higher assembly item and make alternate selections for parts when the required replacement part or assembly is not immediately available.

COLUMN CALLOUT DESCRIPTION

Figure & Item – Indicates the figure number and item number of each part.

Description – Lists the name of the part and pertinent specifications (when required). Asterisks preceding the description denote the subordination of the part to the next higher assembly.

DEC Part No. – Lists the DEC part ordering number. A blank in this column indicates a DEC part number was not assigned at the time of publication

ECO Cut-In – The notation at the top of this column indicates the ECO level of the system (option), at which the IPB was initially prepared. Subsequent ECO level designations, that modify existing parts or add new parts to the device, are inserted in the ECO Cut-In column next to the part that is added or modified. A bracket ([]) preceding the item description is used to indicate the parts affected by ECO's.

Vendor Code/Part No. – Indicates vendor parts that are not stocked by DEC. Refer to the Field Service Spares Catalog (vendor part number to DEC part number) for the vendor code cross-reference.

Used On Code – Letters in this column correspond to the variation codes assigned in Figure 1. Parts with an Alpha notation(s) are used only in those option variations. A blank indicates that the part is used on all option variations.

Ref Fig No. – A cross reference between illustrations. For each Major Assembly, the number in this column denotes the figure of the next higher assembly. For all subassemblies, the number in this column denotes the figure showing additional detailed breakdown.

SYMBOL USAGE

Hardware Designators – Alpha designators for screws (S), washers (W), nuts (N), and retaining rings (R) are inserted after the item number callouts on the illustration when stacked item numbers are used.

Attaching Hardware – The @ symbol is inserted before any part that is used as attaching hardware. Attaching hardware is denoted as those parts that are not an integral part of the referenced assembly.

(NFR) Not Field Repairable – The (NFR) symbol is inserted after any assembly that is not to be field dismantled.

Other Symbols – Any other symbols that are required for kits, accessories, etc., will be explained and appear as part of the item description

REVISION HISTORY			OTHER IPB MANUALS REQUIRED TO SUPPORT THIS OPTION
PRINTING	ECO LEVEL	DATE	
1st Printing	TK50-D/R 00000-00000	8-26-85	EK-0TK50-IP
	70-22316 00000-00000		
	70-22314 00000-00000		
	70-22315 00000-00000		
	H9302 00000-00000		
	70-21261 00000-00000		
	70-21262 00002-00002		

Copyright © 1985 by Digital Equipment Corporation. All rights reserved.

DEC reserves the right, without notice, to make substitutions and modifications in the specifications of products documented in this manual and further reserves the right to withdraw any of these products from the market without notice.

DEC is not responsible for errors which may appear in the technical description (including illustrations and photographs) of the products covered by this manual.

None of the descriptions contained in this manual imply the granting of any license whatsoever to make, use or sell equipment constructed in accordance therewith.

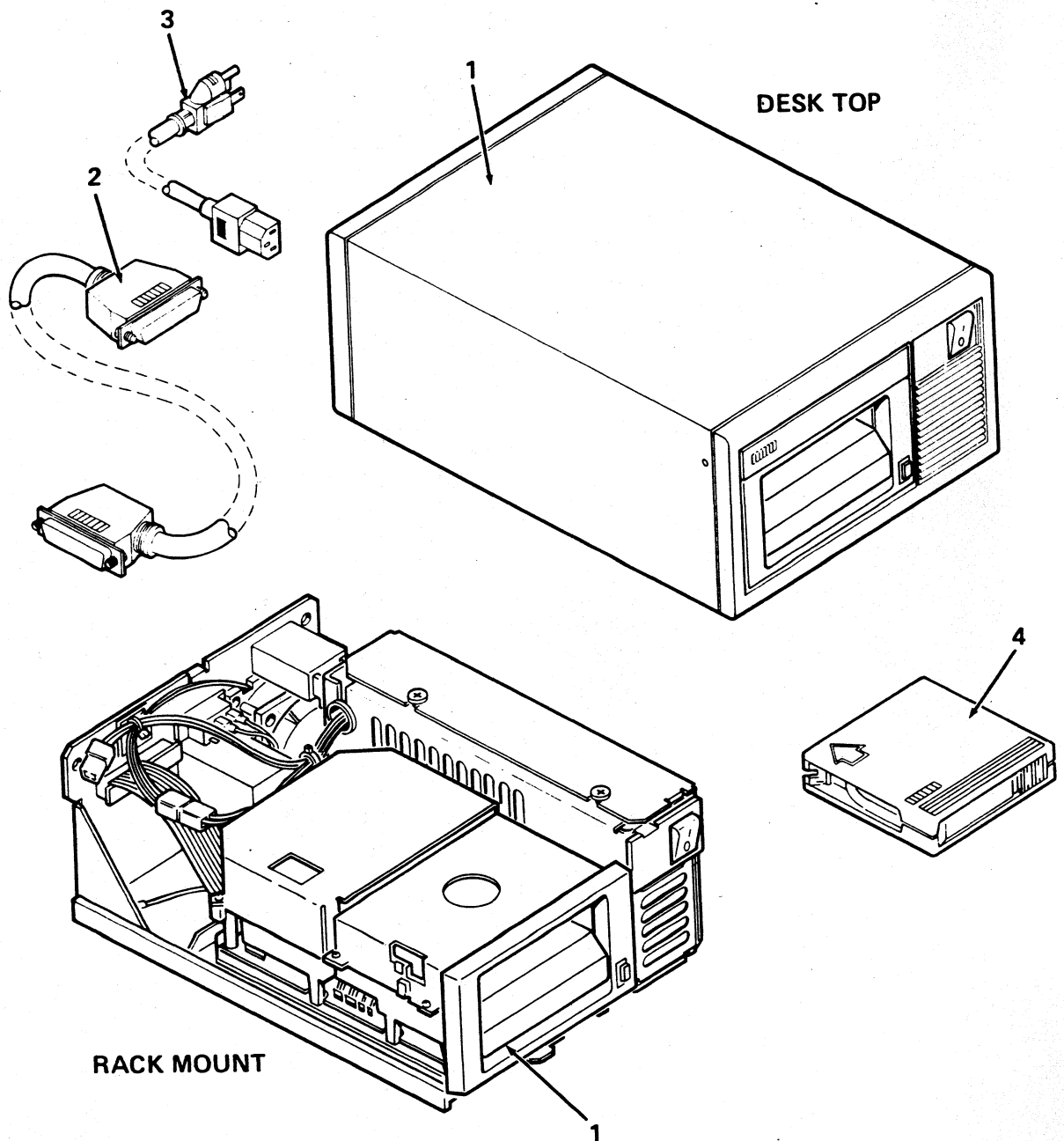

TK50D/R-01

Figure 1. TK50 Desk Top/Rack Mount Assembly

FIG. & ITEM NO.	DESCRIPTION	DEC PART NO. ^A	ECO CUT-IN TK50-DR 00000	USED ON CODE	REF FIG NO.
1-	TK50 TAPE DRIVE SUBSYSTEM				
	Code A - Used on Model TK50-DA DESK TOP TAPE DRIVE ASSEMBLY (120V, 60HZ)	TK50-DA		A	
	Code B - Used on Model TK50-DB DESK TOP TAPE DRIVE ASSEMBLY (240V, 50HZ)	TK50-DB		B	
	Code C - Used on Model TK50-RA RACK MOUNT TAPE DRIVE ASSEMBLY (120V, 60HZ) (See Note)	TK50-RA		C	
	Code D - Used on Model TK50-RB RACK MOUNT TAPE DRIVE ASSEMBLY (240V, 50HZ) (See Note)	TK50-RB		D	
1	*TK50-D UNIT ASSEMBLY (120V, 60HZ)	70-22316-01		A	2
1	*TK50-D UNIT ASSEMBLY (240V, 50HZ)	70-22316-02		B	2
1	*TK50-R UNIT ASSEMBLY (120V, 60HZ)	70-22314-01		C	3
1	*TK50-R UNIT ASSEMBLY (240V, 50HZ)	70-22314-02		D	3
2	*I/O Cable Assembly	17-00484-01			
3	*Power Cord (125V)	17-00083-09		A,C	
3	*Power Cord (250V)	17-00083-10		B,D	
4	*Cartridge, 1/2" for TK50	TK50-K			
	Note: RACK MOUNT KIT	H9302-00		C,D	5

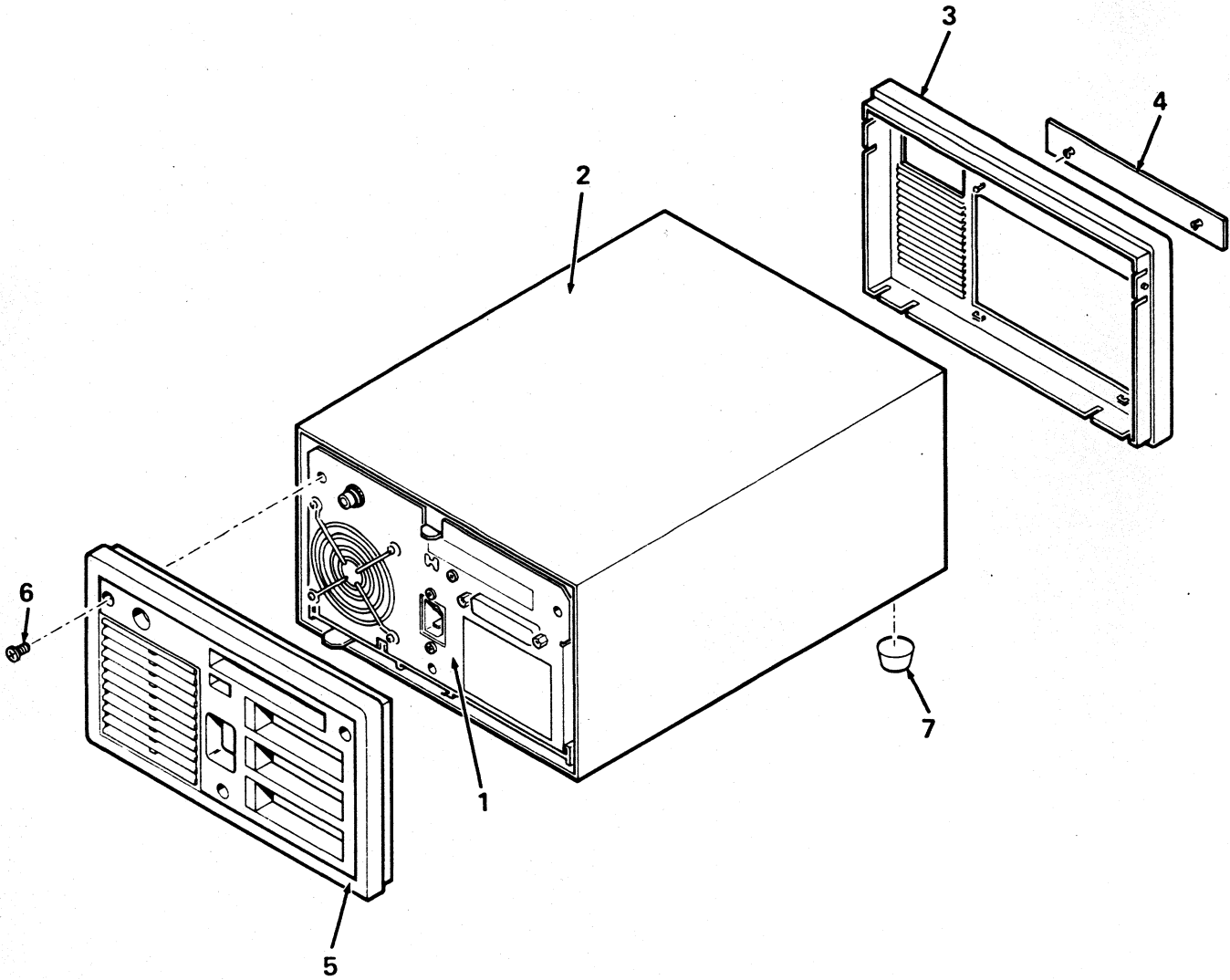

TK50D/R-02

Figure 2. TK50-D Unit Assembly

FIG. & ITEM NO.	DESCRIPTION	DEC PART NO.	ECO CUT-IN 70-22316 00000	USED ON CODE	REF FIG NO.
2--	TK50-D UNIT ASSEMBLY	70-22316-01		A	1
	TK50-D UNIT ASSEMBLY	70-22316-02		B	1
1	*TK CHASSIS ASSEMBLY	70-22315-01			4
2	*Table Top Riveted Assembly	70-21144-01			
3	*Bezel, Front	74-29113-01			
4	*Logo, Snap-in	74-29647-03			
5	*Bezel, Rear	74-29114-02			
6	*Screw, Sems Pan Hd No. 6-32 x 1/2	90-00049-24			
7	*Bumper	90-10117-00			
	Labels (Not Shown)				
	*Label, "Assembled in USA"	36-22764-01			
	*Label, "FCC, Class A"	36-17880-03		A	
	*Label, "FCC, Class A"	36-17880-11		A	
	*Label, "Electrical Data"	36-22763-09			
	*Label, "Warning Equipment Rating 100V"	36-17905-16		A	
	*Label, "Warning Equipment Rating 200V"	36-17905-17		B	

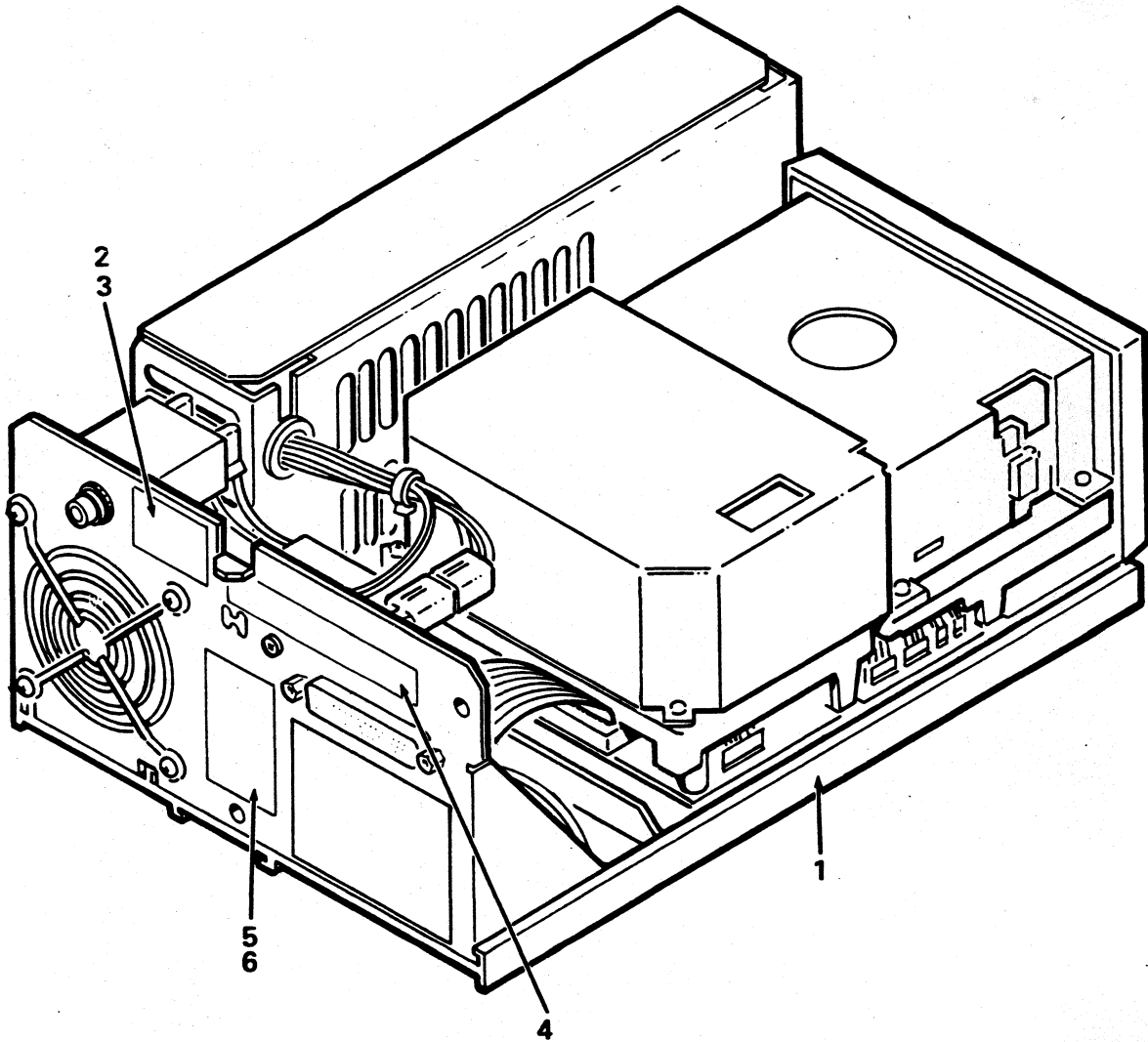

TK50D/R-03

Figure 3. TK50-R Unit Assembly

FIG. & ITEM NO.	DESCRIPTION	DEC PART NO.	ECO CUT-IN 70-22314 0000	USED ON CODE	REF FIG NO.
3-	TK50-R UNIT ASSEMBLY	70-22314-01		C	1
	TK50-R UNIT ASSEMBLY	70-22314-02		D	1
1	*TK CHASSIS ASSEMBLY	70-22315-01			4
2	*Label, "FCC, Class A"	36-17880-03		D	
3	*Label, "FCC, Class A"	36-17880-11		C	
4	*Label, "Electrical Data"	36-22763-09			
5	*Label, "Warning 120V, 60 Hz"	36-17905-01		C	
6	*Label, "Warning Equipment Rating 200V"	36-17905-17		D	

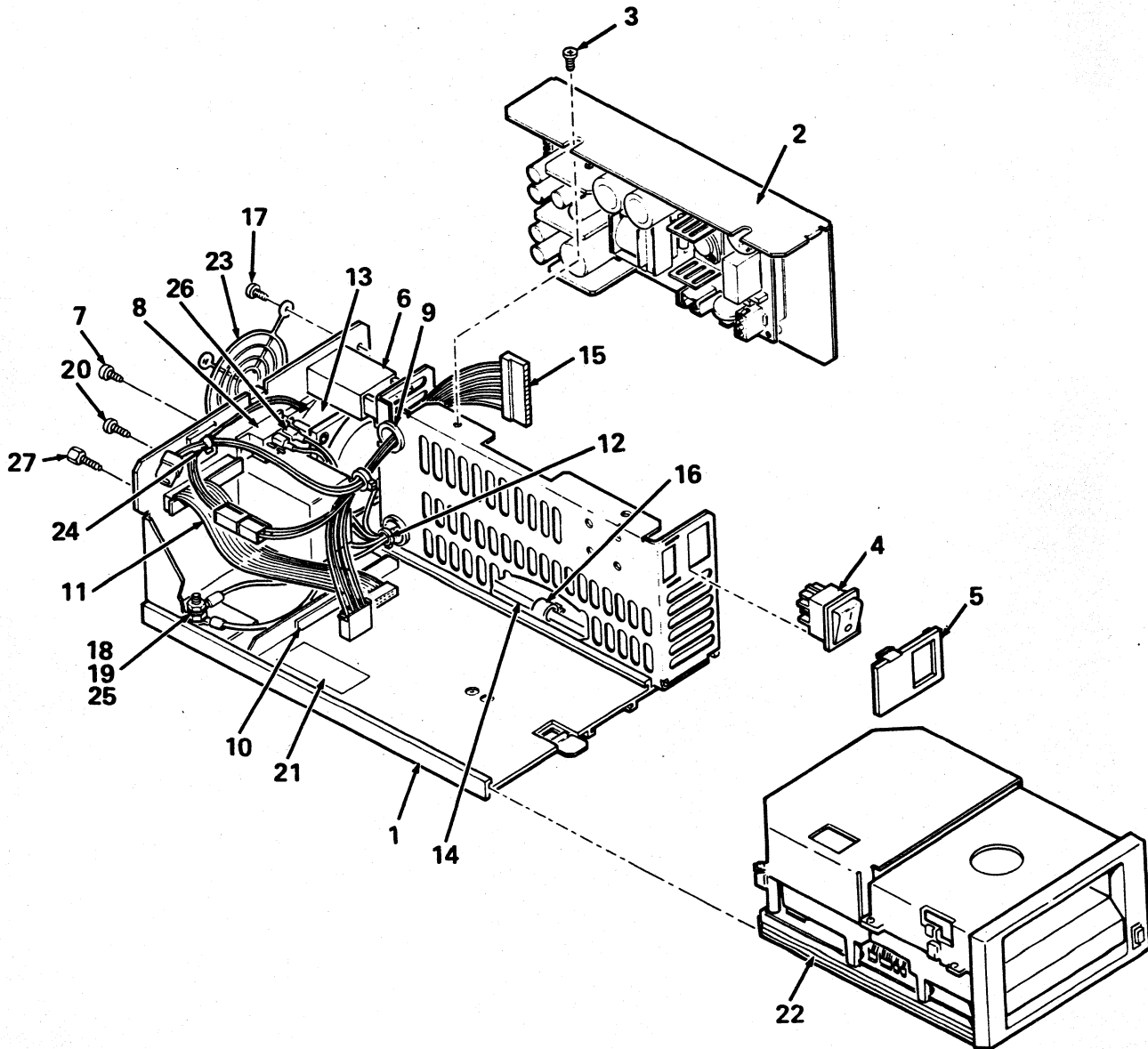

TK50D/R-04

Figure 4. TK Chassis Assembly

FIG. & ITEM NO.	DESCRIPTION	DEC PART NO.	ECO CUT-IN 70-22315 00000	USED ON CODE	REF FIG NO.
4-	TK CHASSIS ASSEMBLY	70-22315-01			2,3
1	* Riveted Chassis Assembly	70-22317-01			
2	*POWER SUPPLY ASSEMBLY	70-21261-01			6
3	*Screw, Phl Flt Hd No. 6-32 x 3/16	90-08020-02			
4	*Switch, Rocker 16A	12-17051-04			
5	* Bezel, Switch	74-31373-01			
6	*Circuit Breaker (4A, 250V)	12-19912-02			
7	*Screw, Sems Phl Pan Hd No. 6-32 x 3/8	90-10174-00			
8	*Switch, Slide	12-16901-04			
9	*Bushing, Snap in	90-10174-00			
10	*Rubber Pad	12-20160-01			
11	*Cable Assembly	17-01046-01			
12	*Cable Tie	90-07031-00			
13	*Fan Assembly	70-21260-01			
14	*A.C. HARNESS ASSEMBLY	70-21262-01			7
15	*D.C. Harness Assembly	70-21263-01			
16	*Cable Clip	90-08340-00			
17	*Screw, Phl Self Tap No. 10-24 x 3/8	90-09813-00			
18	*Nut, Kep No. 10-32	90-06565-00			
19	*Washer, Lock No. 6	90-06636-00			
20	*Screw, Phl Self Tap No. 8-32 1/4	90-09312-00			
21	*Label, "Assembled in USA"	36-22764-01			
22	*TK50 Drive (See TK50 IPB)	TK50-00			
23	*Guard, Finger	12-12580-00			
24	*Cable Clamp	90-09771-02			
25	*Washer, Flat	90-06664-00			
26	*Terminal, Quick Disconnect	12-17000-01			
27	*Screw, Hex Washer Hd	90-08451-06			

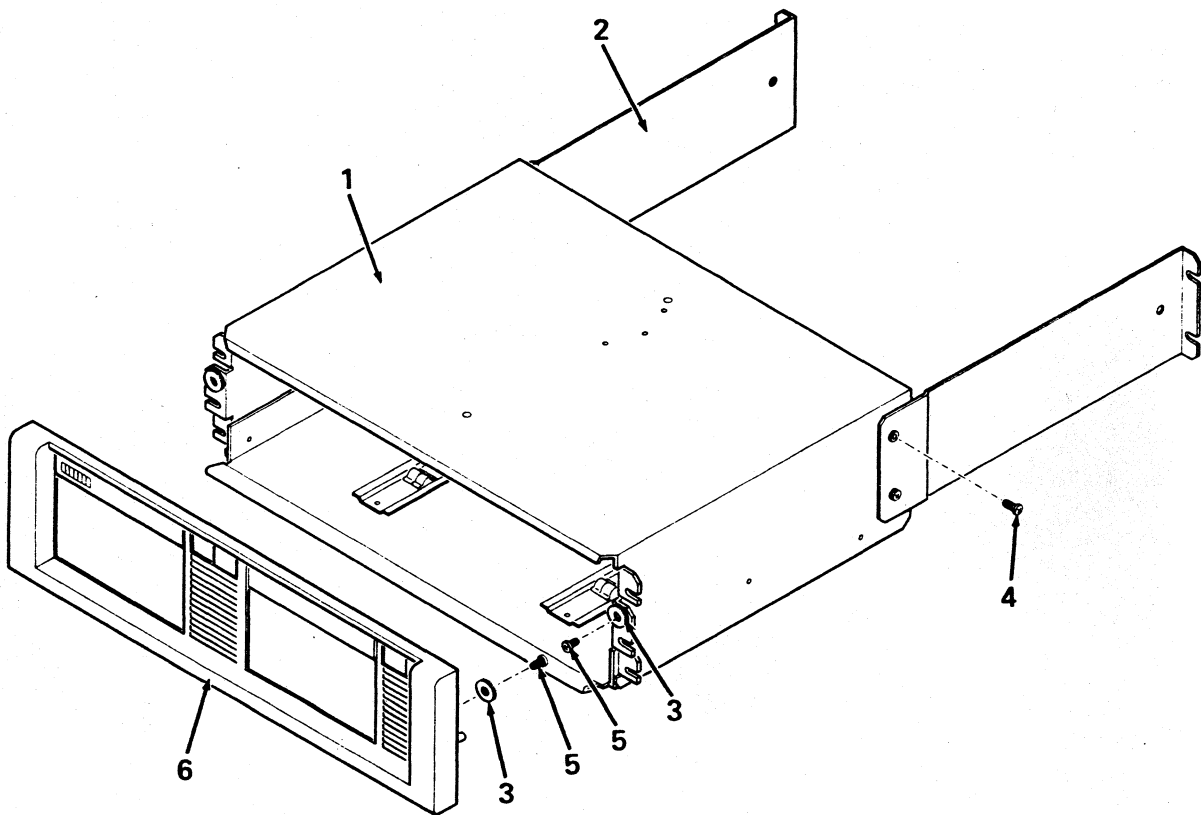

TK50D/R-05

Figure 5. Rack Mount Kit

FIG. & ITEM NO.	DESCRIPTION	DEC PART NO.	ECO CUT-IN H9302 00000	USED ON CODE	REF FIG NO.
5-	RACK MOUNT KIT	H9302-00		C,D	1
1	*Rack Mount Riveted Assembly	70-21145-01			
2	*Bracket, Support	74-29121-01			
3	*Fastner, Screw Mount	90-09712-00			
4	*Screw, Self Tap Phl Pan Hd No. 6-18 x 1/4	90-09800-02			
5	*Screw, Sems Phl Pan Hd No. 6-32 x 1/4	90-10174-00			
6	*Bezel, Blank (See Note)	74-29117-01			
7	*Hardware Kit (Not Shown) (See Note)	22-00053-01			
	<p>Note: Items 6 and 7 are shipped loose in bags. See installation Manual.</p>				

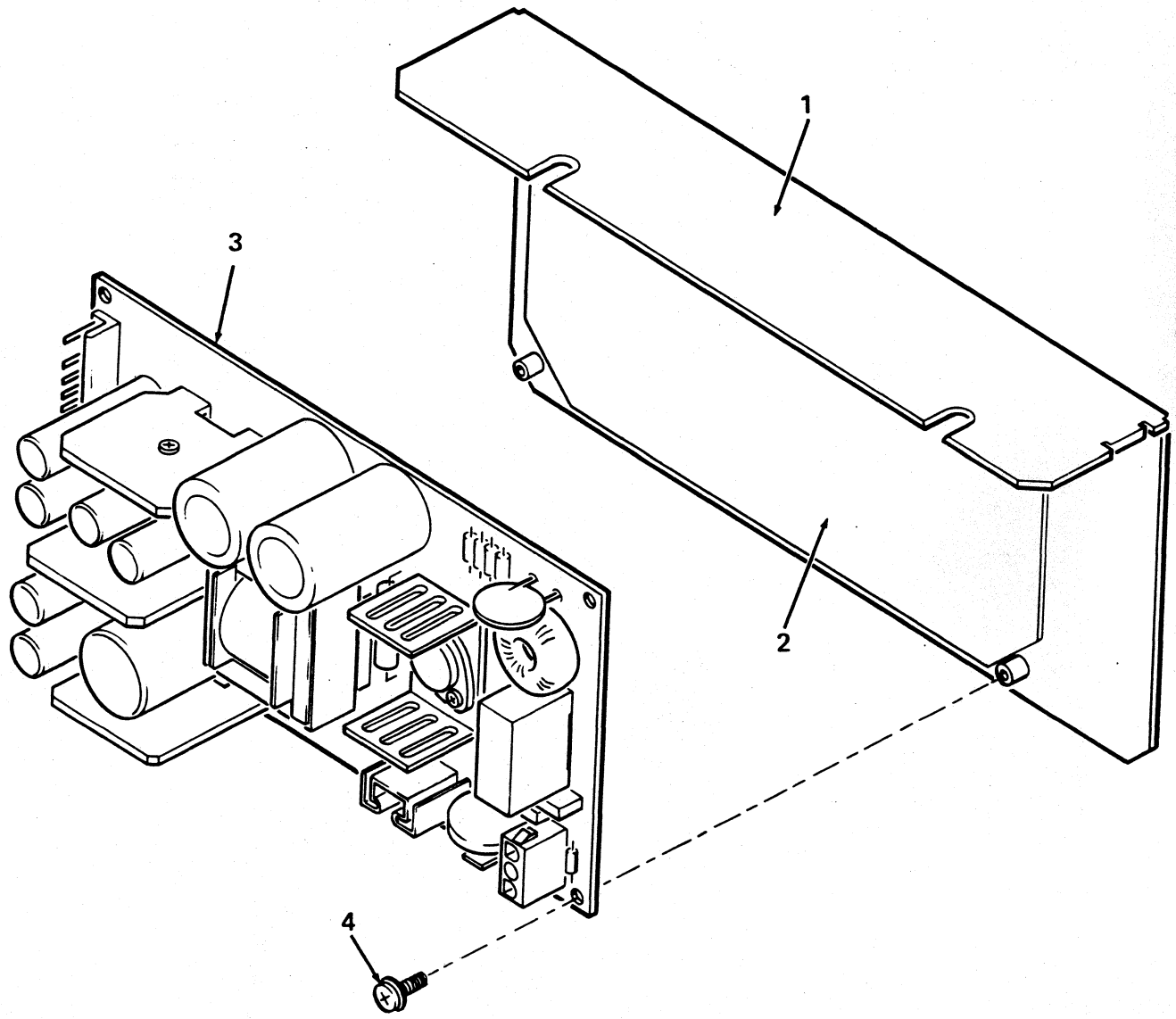

TK50D/R-06

Figure 6. Power Supply Assembly

FIG. & ITEM NO.	DESCRIPTION	DEC PART NO.	ECO CUT-IN 70-21261 00000	USED ON CODE	REF FIG NO.
6-	POWER SUPPLY ASSEMBLY	70-21261-01			3
1	*Box, Power Supply	74-29125-01			
2	*Insulator, Plastic	74-29701-01			
3	*Power Supply 5V, 2A, 65W, 3 Outputs	30-22561-01			
4	*Screw, Sems Phi Pan Hd No. 6-32 x 3/8	90-10174-00			

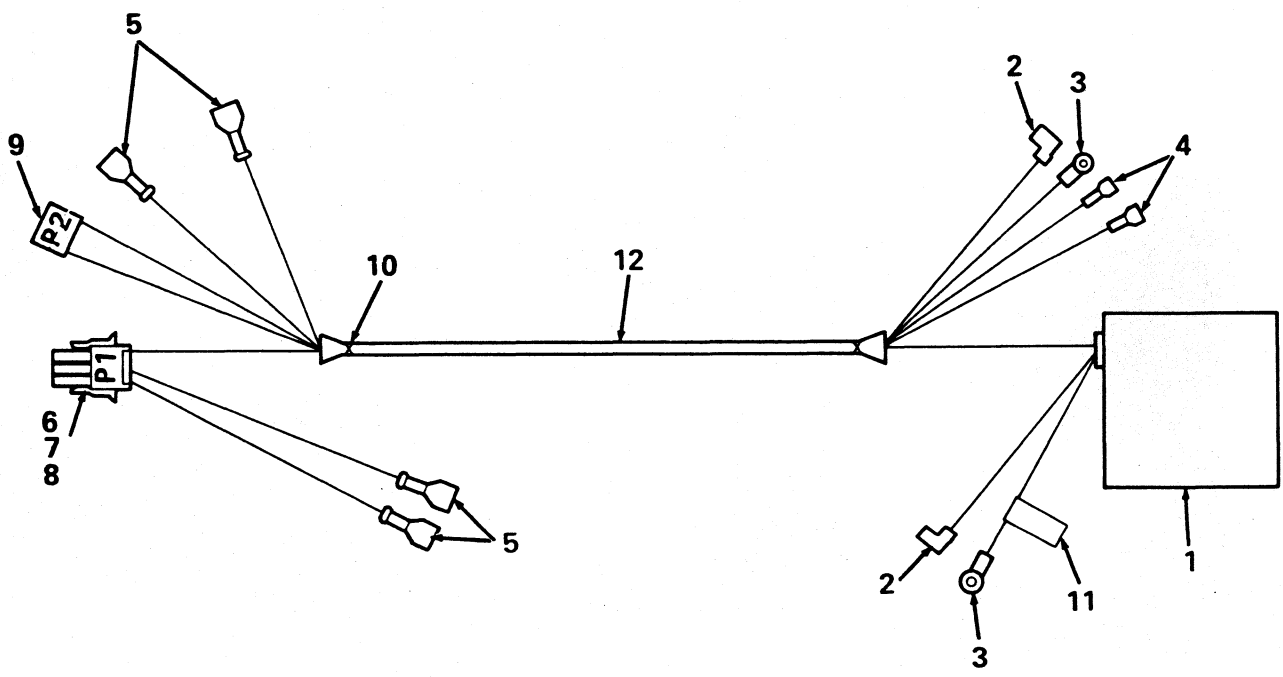

TK50D/R-07

Figure 7. A.C. Harness Assembly

FIG. & ITEM NO.	DESCRIPTION	DEC PART NO.	ECO CUT-IN 70-21262 00002	USED ON CODE	REF FIG NO.
7-	A.C. HARNESS ASSEMBLY	70-21262-01			3
1	*Line Filter, 120/240V, 12A, EMI	12-16382-02			
2	*Terminal, Quick Disconnect	12-17855-00			
3	*Terminal, Ring	90-07930-00			
4	*Terminal, Quick Disconnect	12-17000-01			
5	*Terminal, Quick Disconnect	12-17000-00			
6	*Connector, (P1) 3 Pin Mate-N-Lok	12-12176-00			
7	*Terminal, (P1) Socket	12-12169-00			
8	*Terminal, (P1) Socket	12-17519-00			
9	*Connector, (P2) 6 Pin IDC	12-15815-02			
10	*Cable Tie	90-07031-00			
11	*Label	90-09255-01			
12	*Tubing, Extruded	91-07245-00			

000000

PART NUMBER/DESCRIPTION SORT



TK50-D/R TAPE DRIVE SUBSYSTEM SORTED BY PART NUMBER

PART NO.	DESCRIPTION	FIG. NO.	ITEM
12-12169-00	Terminal, (P1) Socket	7	7
12-12176-00	Connector, (P1) 3 Pin Mate-N-Lok	7	6
12-12580-00	Guard, Finger	4	23
12-15815-02	Connector, (P2) 6 Pin IDC	7	9
12-16382-02	Line Filter, 120/240V, 12A EMI	7	1
12-16901-04	Switch, Slide	4	8
12-17000-00	Terminal, Quick Disconnect	7	5
12-17000-01	Terminal, Quick Disconnect	4	26
12-17000-01	Terminal, Quick Disconnect	7	4
12-17051-04	Switch, Rocker 16A	4	4
12-17519-00	Terminal, (P1) Socket	7	8
12-17855-00	Terminal, Quick Disconnect	7	2
12-19912-02	Circuit Breaker (4A, 250V)	4	6
12-20160-01	Rubber Pad	4	10
17-00083-09	Power Cord (125V)	1	3
17-00083-10	Power Cord (250V)	1	3A
17-00484-01	I/O Cable Assembly	1	2
17-01046-01	Cable Assembly	4	11
22-00053-01	Hardware Kit (Not Shown)	5	7
30-22561-01	Power Supply 5V, 2A, 65W, 3 Outputs	6	3
36-17880-03	Label, "FCC, Class A"	3	2
36-17880-03	Label, "FCC, Class A"	2	N/S
36-17880-11	Label, "FCC, Class A"	2	N/S
36-17880-11	Label, "FCC, Class A"	3	3
36-17905-01	Label, "Warning 120V, 60Hz"	3	5
36-17905-16	Label, "Warning Equipment Rating 100V"	2	N/S
36-17905-17	Label, "Warning Equipment Rating 200V"	2	N/S
36-17905-17	Label, "Warning Equipment Rating 200V"	3	6
36-22763-09	Label, "Electrical Data"	3	4
36-22763-09	Label, "Electrical Data"	2	N/S
36-22764-01	Label, "Assembled in USA"	4	21
36-22764-01	Label, "Assembled in USA"	2	N/S
70-21144-01	Table Top Riveted Assembly	2	2
70-21145-01	Rack Mount Riveted Assembly	5	1
70-21260-01	Fan Assembly	4	13
70-21261-01	POWER SUPPLY ASSEMBLY	4	2
70-21261-01	POWER SUPPLY ASSEMBLY	6	0
70-21262-01	A.C. HARNESS ASSEMBLY	4	14
70-21262-01	A.C. HARNESS ASSEMBLY	7	0
70-21263-01	D.C. Harness Assembly	4	15
70-22314-01	TK50-R UNIT ASSEMBLY	3	0
70-22314-01	TK50-R UNIT ASSEMBLY (120V, 60HZ)	1	1B
70-22314-02	TK50-R UNIT ASSEMBLY	3	0A
70-22314-02	TK50-R UNIT ASSEMBLY (240V, 50HZ)	1	1C
70-22315-01	TK CHASSIS ASSEMBLY	3	1
70-22315-01	TK CHASSIS ASSEMBLY	4	0
70-22315-01	TK CHASSIS ASSEMBLY	2	1
70-22316-01	TK50-D UNIT ASSEMBLY	2	0

N/S=Not Shown

TK50-D/R TAPE DRIVE SUBSYSTEM SORTED BY PART NUMBER

PART NO.	DESCRIPTION	FIG. NO.	ITEM
70-22316-01	TK50-D UNIT ASSEMBLY (120V, 60HZ)	1	1
70-22316-02	TK50-D UNIT ASSEMBLY (240V, 50HZ)	1	1A
70-22316-02	TK50-D UNIT ASSEMBLY	2	0A
70-22317-01	Riveted Chassis Assembly	4	1
74-29113-01	Bezel, Front	2	3
74-29114-02	Bezel, Rear	2	5
74-29117-01	Bezel, Blank (Not Shown)	5	6
74-29121-01	Bracket, Support	5	2
74-29125-01	Box, Power Supply	6	1
74-29647-03	Logo, Snap-in	2	4
74-29701-01	Insulator, Plastic	6	2
74-31373-01	Bezel, Switch	4	5
90-00049-24	Screw, Sems Pan Hd No. 6-32 x 1/2	2	6
90-06565-00	Nut, Kep No. 10-32	4	18
90-06636-00	Washer, Lock No. 6	4	19
90-06664-00	Washer, Flat	4	25
90-07031-00	Cable Tie	7	10
90-07031-00	Cable Tie	4	12
90-07930-00	Terminal, Ring	7	3
90-08020-02	Screw, Phl Flt Hd No. 6-32 x 3/16	4	3
90-08340-00	Cable Clip	4	16
90-08451-06	Screw, Hex Washer Hd	4	27
90-09255-01	Label	7	11
90-09312-00	Screw, Phl Self Tap No. 8-32 1/4	4	20
90-09712-00	Fastner, Screw Mount	5	3
90-09771-02	Cable Clamp	4	24
90-09800-02	Screw, Self Tap Phl Pan Hd No. 6-18 x 1/4	5	4
90-09813-00	Screw, Phl Self Tap No. 10-24 x 3/8	4	17
90-10117-00	Bumper	2	7
90-10174-00	Screw, Sems Phl Pan Hd No. 6-32 x 3/8	4	7
90-10174-00	Bushing, Snap in	4	9
90-10174-00	Screw, Sems Phl Pan Hd No. 6-32 x 1/4	5	5
90-10174-00	Screw, Sems Phl Pan Hd No. 6-32 x 3/8	6	4
91-07245-00	Tubing, Extruded	7	12
H9302-00	RACK MOUNT KIT	5	0
TK50-00	5.25 in. Cartridge	4	22
TK50-DA	Code A - Used on Model TK50-DA DESK TOP TAPE DRIVE ASSEMBLY (120V, 60HZ)	1	0A
TK50-DB	Code B - Used on Model TK50-DB DESK TOP TAPE DRIVE ASSEMBLY (240V, 50HZ)	1	0B
TK50-K	Cartridge, 1/2" for TK50	1	4
TK50-RA	Code C - Used on Model TK50-RA RACK MOUNT TAPE DRIVE ASSEMBLY (120V, 60HZ)	1	0C
TK50-RB	Code D - Used on Model TK50-RB RACK MOUNT TAPE DRIVE ASSEMBLY (240V, 50HZ)	1	0D
	TK50 TAPE DRIVE SUBSYSTEM	1	0

TK50-D/R TAPE DRIVE SUBSYSTEM SORTED BY DESCRIPTION

DESCRIPTION	PART NO.	FIG. NO.	ITEM
5.25 in. Cartridge	TK50-00	4	22
A.C. HARNESS ASSEMBLY	70-21262-01	7	0
A.C. HARNESS ASSEMBLY	70-21262-01	4	14
Bezel, Blank (Not Shown)	74-29117-01	5	6
Bezel, Front	74-29113-01	2	3
Bezel, Rear	74-29114-02	2	5
Bezel, Switch	74-31373-01	4	5
Box, Power Supply	74-29125-01	6	1
Bracket, Support	74-29121-01	5	2
Bumper	90-10117-00	2	7
Bushing, Snap in	90-10174-00	4	9
Cable Assembly	17-01046-01	4	11
Cable Clamp	90-09771-02	4	24
Cable Clip	90-08340-00	4	16
Cable Tie	90-07031-00	7	10
Cable Tie	90-07031-00	4	12
Cartridge, 1/2" for TK50	TK50-K	1	4
Circuit Breaker (4A, 250V)	12-19912-02	4	6
Code A - Used on Model TK50-DA DESK TOP TAPE DRIVE ASSEMBLY (120V, 60HZ)	TK50-DA	1	0A
Code B - Used on Model TK50-DB DESK TOP TAPE DRIVE ASSEMBLY (240V, 50HZ)	TK50-DB	1	0B
Code C - Used on Model TK50-RA RACK MOUNT TAPE DRIVE ASSEMBLY (120V, 60HZ)	TK50-RA	1	0C
Code D - Used on Model TK50-RB RACK MOUNT TAPE DRIVE ASSEMBLY (240V, 50HZ)	TK50-RB	1	0D
Connector, (P1) 3 Pin Mate-N-Lok	12-12176-00	7	6
Connector, (P2) 6 Pin IDC	12-15815-02	7	9
D.C. Harness Assembly	70-21263-01	4	15
Fan Assembly	70-21260-01	4	13
Fastner, Screw Mount	90-09712-00	5	3
Guard, Finger	12-12580-00	4	23
Hardware Kit (Not Shown)	22-00053-01	5	7
I/O Cable Assembly	17-00484-01	1	2
Insulator, Plastic	74-29701-01	6	2
Label	90-09255-01	7	11
Label, "Assembled in USA"	36-22764-01	4	21
Label, "Assembled in USA"	36-22764-01	2	N/S
Label, "Electrical Data"	36-22763-09	3	4
Label, "Electrical Data"	36-22763-09	2	N/S
Label, "FCC, Class A"	36-17880-03	2	N/S
Label, "FCC, Class A"	36-17880-03	3	2
Label, "FCC, Class A"	36-17880-11	3	3
Label, "FCC, Class A"	36-17880-11	2	N/S

N/S=Not Shown

TK50-D/R TAPE DRIVE SUBSYSTEM SORTED BY DESCRIPTION

DESCRIPTION	PART NO.	FIG. NO.	ITEM
Label, "Warning 120V, 60Hz"	36-17905-01	3	5
Label, "Warning Equipment Rating 100V"	36-17905-16	2	N/S
Label, "Warning Equipment Rating 200V"	36-17905-17	3	6
Label, "Warning Equipment Rating 200V"	36-17905-17	2	N/S
Line Filter, 120/240V, 12A EMI	12-16382-02	7	1
Logo, Snap-in	74-29647-03	2	4
Nut, Kep No. 10-32	90-06565-00	4	18
Power Cord (125V)	17-00083-09	1	3
Power Cord (250V)	17-00083-10	1	3A
Power Supply 5V, 2A, 65W, 3 Outputs	30-22561-01	6	3
POWER SUPPLY ASSEMBLY	70-21261-01	4	2
POWER SUPPLY ASSEMBLY	70-21261-01	6	0
RACK MOUNT KIT	H9302-00	5	0
Rack Mount Riveted Assembly	70-21145-01	5	1
Riveted Chassis Assembly	70-22317-01	4	1
Rubber Pad	12-20160-01	4	10
Screw, Hex Washer Hd	90-08451-06	4	27
Screw, Phl Flt Hd No. 6-32 x 3/16	90-08020-02	4	3
Screw, Phl Self Tap No. 10-24 x 3/8	90-09813-00	4	17
Screw, Phl Self Tap No. 8-32 1/4	90-09312-00	4	20
Screw, Self Tap Phl Pan Hd No. 6-18 x 1/4	90-09800-02	5	4
Screw, Sems Pan Hd No. 6-32 x 1/2	90-00049-24	2	6
Screw, Sems Phl Pan Hd No. 6-32 x 1/4	90-10174-00	5	5
Screw, Sems Phl Pan Hd No. 6-32 x 3/8	90-10174-00	4	7
Screw, Sems Phl Pan Hd No. 6-32 x 3/8	90-10174-00	6	4
Switch, Rocker 16A	12-17051-04	4	4
Switch, Slide	12-16901-04	4	8
Table Top Riveted Assembly	70-21144-01	2	2
Terminal, (P1) Socket	12-12169-00	7	7
Terminal, (P1) Socket	12-17519-00	7	8
Terminal, Quick Disconnect	12-17000-00	7	5
Terminal, Quick Disconnect	12-17000-01	7	4
Terminal, Quick Disconnect	12-17000-01	4	26
Terminal, Quick Disconnect	12-17855-00	7	2
Terminal, Ring	90-07930-00	7	3
TK CHASSIS ASSEMBLY	70-22315-01	4	0
TK CHASSIS ASSEMBLY	70-22315-01	2	1
TK CHASSIS ASSEMBLY	70-22315-01	3	1
TK50 TAPE DRIVE SUBSYSTEM		1	0
TK50-D UNIT ASSEMBLY	70-22316-02	2	0A
TK50-D UNIT ASSEMBLY	70-22316-01	2	0
TK50-D UNIT ASSEMBLY (120V, 60HZ)	70-22316-01	1	1
TK50-D UNIT ASSEMBLY (240V, 50HZ)	70-22316-02	1	1A
TK50-R UNIT ASSEMBLY	70-22314-02	3	0A
TK50-R UNIT ASSEMBLY	70-22314-01	3	0
TK50-R UNIT ASSEMBLY (120V, 60HZ)	70-22314-01	1	1B
TK50-R UNIT ASSEMBLY (240V, 50HZ)	70-22314-02	1	1C
Tubing, Extruded	91-07245-00	7	12

N/S=Not Shown

TK50-D/R TAPE DRIVE SUBSYSTEM SORTED BY DESCRIPTION

DESCRIPTION	PART NO.	FIG. NO.	ITEM
Washer, Flat	90-06664-00	4	25
Washer, Lock No. 6	90-06636-00	4	19

**ILLUSTRATED PARTS BREAKDOWN
COMMENT SHEET**

Any and all comments and suggestions for correcting errors and/or additional information to improve this manual will be reviewed and researched for possible use when this manual is revised and/or reprinted. Enter your comments and suggestions in the form provided below and return to Technical Documentation.

MODEL TK50-D/R TAPE DRIVE SUBSYSTEM

PUBLICATION NO. EK-LEP05-IP-001

FIGURE NO. _____ ITEM NO. _____

FIGURE NO. _____ ITEM NO. _____

CHANGE FROM _____

CHANGE FROM _____

CHANGE TO _____

CHANGE TO _____

FIGURE NO. _____ ITEM NO. _____

FIGURE NO. _____ ITEM NO. _____

CHANGE FROM _____

CHANGE FROM _____

CHANGE TO _____

CHANGE TO _____

FIGURE NO. _____ ITEM NO. _____

FIGURE NO. _____ ITEM NO. _____

CHANGE FROM _____

CHANGE FROM _____

CHANGE TO _____

CHANGE TO _____

ADDITIONAL COMMENT(S)

Please describe your position. _____

Name _____ Organization _____

Street _____ Department _____

City _____ State _____ Zip or Country _____

Fold Here-----

Do Not Tear - Fold Here and Staple-----

digital



No Postage
Necessary
If Mailed in the
United States

BUSINESS REPLY MAIL
FIRST CLASS PERMIT NO. 33 MAYNARD, MA.

POSTAGE WILL BE PAID BY ADDRESSEE

Digital Equipment Corporation
Educational Services
129 Parker Street, PK03-2/H31
Maynard, MA 01754

